

HD

**Material**

Aluminium

**Finish**

Highly polished

**Thread**

Machined thread

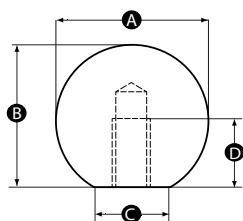

Part No.	A	B	C	D	Thread size
15340R	16	15	8	7	M4
15341Y	16	15	8	7	M5
15342U	16	15	8	7	M6
15343Q	20	18	12	9	M4
15344X	20	18	12	9	M5
15345T	20	18	12	9	M6
15346P	25	23	15	11	M6
15347W	25	23	15	11	M8
15348S	25	23	15	11	M10
15349Z	32	29	18	15	M6
15350V	32	29	18	15	M8
15351R	32	29	18	15	M10
15352Y	38	35	22	18	M6
15353U	38	35	22	18	M8
15354Q	38	35	22	18	M10
15355X	44	37	32	20	M10
15356T	50	46	28	21	M10