

HD SS

Material

Stainless steel 304

Finish

Highly polished

Bore

Push-fit assembly

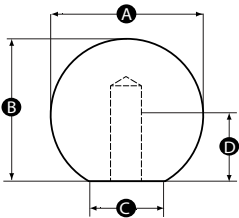

Part No.	A	B	C	D	Bore size (mm) - H7 Tolerance
15357P	16	15	8	10	4
15358W	16	15	8	10	5
15359S	20	18	12	12	5
15360Z	20	18	12	12	6
15361V	25	23	15	16	6
15362R	25	23	15	16	8
15363Y	32	29	18	20	6
15364U	32	29	18	20	8
15365Q	38	35	22	24	6
15366X	38	35	22	24	8
15367T	38	35	22	24	10
15368P	44	37	32	28	10