

HD SS

Material

Stainless steel 304

Finish

Highly polished

Thread

Machined thread

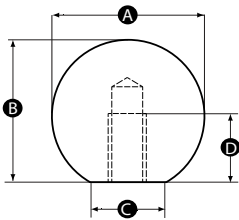

Part No.	A	B	C	D	Thread size
15323T	16	15	8	7	M4
15324P	16	15	8	7	M5
15325W	16	15	8	7	M6
15326S	20	18	12	9	M4
15327Z	20	18	12	9	M5
15328V	20	18	12	9	M6
15329R	25	23	15	11	M6
15330Y	25	23	15	11	M8
15331U	25	23	15	11	M10
15332Q	32	29	18	15	M6
15333X	32	29	18	15	M8
15334T	32	29	18	15	M10
15335P	38	35	22	18	M6
15336W	38	35	22	18	M8
15337S	38	35	22	18	M10
15338Z	44	37	32	20	M10
15339V	50	46	28	21	M10